

DKM-850SV

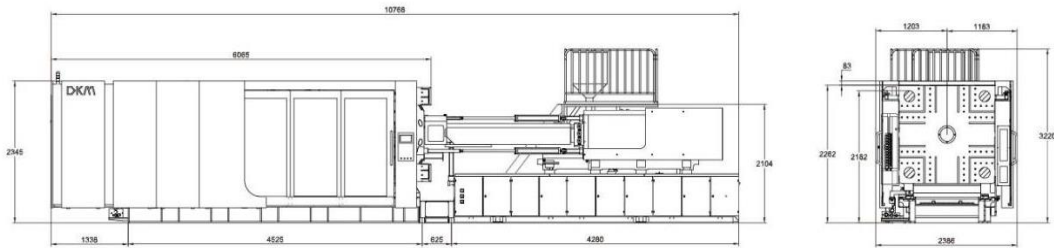

DKM machinery spec.		DKM-850SV			
		A	B	C	D
INJECTION UNIT					
Screw Diameter	mm	90	95	100	110
Screw L/D Ratio	(L/D)	24.8	23.6	22.4	20.4
Shot Volume	cm ³	2980	3325	3685	4460
Injection Weight	g	2682	2993	3317	4014
Injection Pressure	Mpa	207	185	167	137
Plasticizing Rate	(g/s)	71.8	78.2	86.5	104
Screw Speed	rpm	0-130			
CLAMPING UNIT					
Clamping Tonnage	kN	8500			
Toggle Stroke	mm	1040			
Tie Bar Distance	mm	1040×1040			
Max.Mold Height	mm	1040			
Min.Mold Height	mm	420			
Min.Mould Size	mm	720×720			
Ejector Stroke	mm	300			
Ejector Force	kN	210			
Ejector Number	n	21			
OTHERS					
Max.Pump Pressure	Mpa	16			
Pump Motor Power	kW	2×26.7+20.5			
Heater Power	kW	55.4			
Machine Dimension	m	10.8×2.4×3.25			
Machine Weight	t	35.5			
Oil Tank Capacity	L	1000			
Machine Weight	t	30			
Oil Tank Capacity	L	1000			

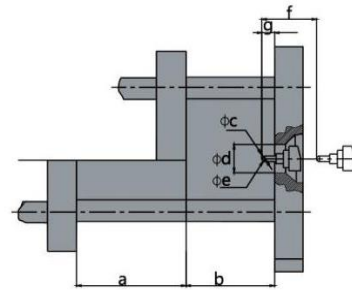

Dimensions

a	b	c	d
1040	420-1040	Φ6	Φ250
e	f	g	
SR15	535	50	

Mold Platen Drawing

